

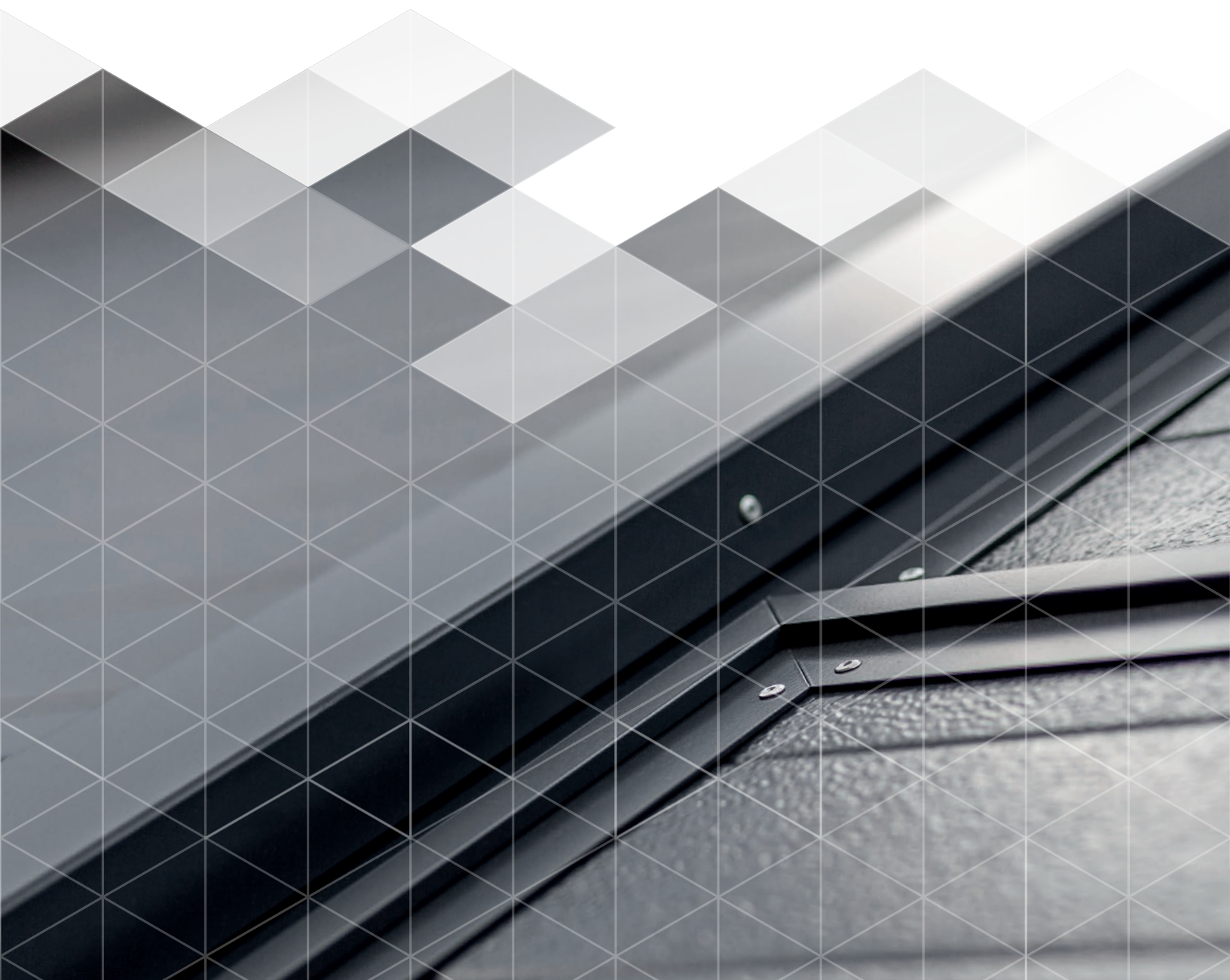

Catálogo de Accesorios y Molduras | Accessories and Trims Catalog



Tornillería y Fijación - Fasteners and Fixing

Tornillería FM - FM Screws and Fasteners

Tornillos Bimetalicos Autotaladrantes de Acero Inoxidable | Stainless Steel Bi-Metal Self Drilling Screw

Grado 304 - Grade 304 (JT3-D-6H-5.5/6.3 x 87 - E16) 

Grado 304 - Grade 304 (JT3-D-6H-5.5/6.3 x 107 - E16) 

Grado 304 - Grade 304 (JT3-D-6H-5.5/6.3 x 127 - E16) 

Grado 304 - Grade 304 (JT3-D-6H-5.5/6.3 x 147 - E16) 

Grado 304 - Grade 304 (JT3-D-6H-5.5/6.3 x 197 - E16) 

Grado 304 - Grade 304 (JT3-D-6H-5.5/6.3 x 237 - E16) 

Grado 304 - Grade 304 (JT3-D-6H-5.5/6.3 x 267 - E16) 

Grado 304 - Grade 304 (JT3-2H 4.8 x 19 - E16) 

Grado 304 - Grade 304 (JT3-6-5.5x50 - E16) 

Pija - Screw-in Pin # 8x½ K-LATHE S/A 

Tornillería Estandar - Standard Screws and Fasteners

Pija Autotaladrante | Self Drilling Screw

MA # 14X1" S/A 

MA # 14X1-1/4" S/A 

MA # 14X1-1/2" S/A 

MA # 14X 2" S/A 

MA # 14X 2 1/2" S/A 

MA # 14X 3" S/A 

MA # 14X 4" S/A 

MA # 14X 5" S/A 

MA # 14X 6" S/A 

MA # 14X 8" S/A 

MA # 14X 10" S/A 

Arandela galvanizada - Galvanized Washing Ring #14X15 

1/4 - 14 x 7/8" low profile stitch tek+ bonded washer 

1/4 - 14 x 7/8" Low profile stitch tek white head+ bonded washer 

Rivets 

1/4" - 14 X 1" Pancake dp3 fastener w/o washer 

3/4" Phil. Pan head 

JT2-3-4,8x19 (For trims) (para molduras) 

Otros Tornillos | Other Fasteners and Screws

Varilla Roscada Galvaniada de ¾"
¾" Galvanized Threaded Rod 

Tuerca Cople Galvanizada de ¾"
¾" Galvanized Coupling Nut 

Tornillo Cabeza Coche Galvanizado de ¾"
¾" Carriage Bolt 

Square Pancake screw #14x4"
Tornillo Pancake #14x4" 

Complementos - Installation Complements

Sanitary Profiles - Perfiles Sanitarios

Description	Descripción	Código / Code	Tamaño / size	RAL 9002 - 9010
PVC Retaining Profile	Perfil de Sujeción en PVC	R 4220	40 mm / 1 9/16"	
PVC Sanitary Cove	Curva Sanitaria en PVC	SB 8008	100 mm / 4"	

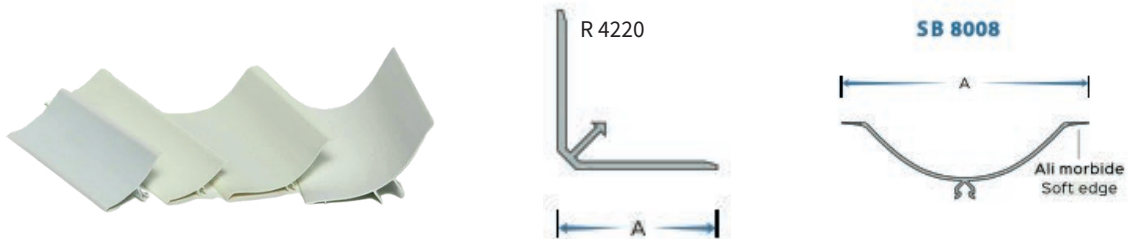

Cove Joints Intersections - Nodos

Description	Descripción	Código / Code	RAL 9002 - 9010
PVC Cove Joins	Nodos de PVC	NPR 010	
PVC Cove Joins	Nodos de PVC	NPR 020	
PVC Cove Joins	Nodos de PVC	NPR 030	
PVC Cove Joins	Nodos de PVC	NPR 040	
PVC Cove Joins	Nodos de PVC	NPR 050	

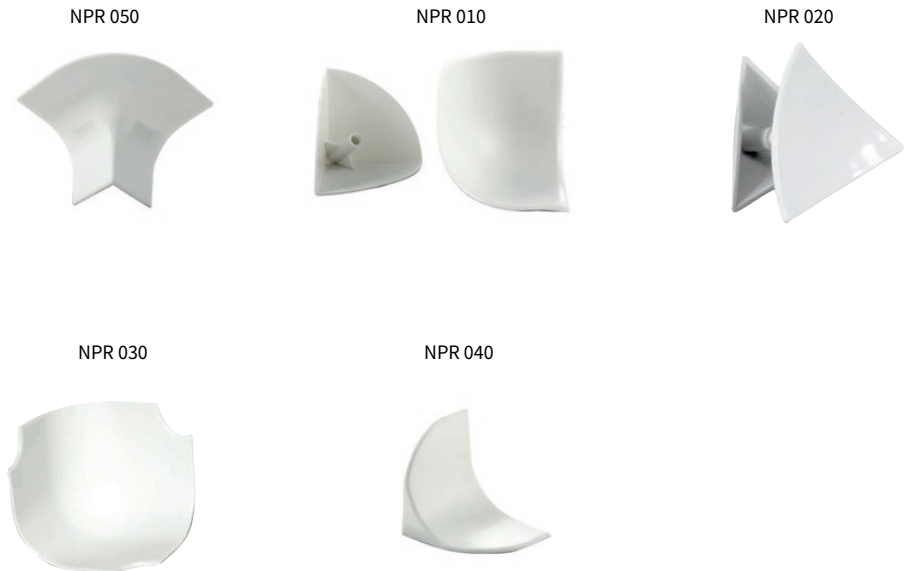

Complementos - Installation Complements

Sanitary Coved Base - Zócalo

Description	Descripción	Código / Code	Tamaño / size	RAL 9002 - 9010
PVC Sanitary Coved Base	Zócalo PVC	SB8051	40 mm - 10 Ft	
PVC Accesory	Accesorio PVC	NPR 001		
PVC Accesory	Accesorio PVC	NPR 002		
PVC Accesory	Accesorio PVC	NPR 003		
PVC Accesory	Accesorio PVC	NPR 004		
PVC Accesory	Accesorio PVC	NPR 005		
PVC Accesory	Accesorio PVC	NPR 006		

NPR 001



NPR 002



NPR 003



NPR 004



NPR 005



NPR 006



Offset U-Channels - Canales U Asimétricos

Description	Descripción	Código / Code	Tamaño / size	Linear working length 10 ft - Long. de trabajo 3 m lineales
U-Channel	Canal U	EX68	50 mm - 2"	
U-Channel	Canal U	EX94	63 mm - 2.5"	
U-Channel	Canal U	EX67	100 mm - 4"	

EX68



EX94



EX67



Complementos - Installation Complements

Threaded Rod - Varilla Roscada

Código / Code	Description	Descripción
TR-M8	Max. Load= 110 lbs Lenght= 3.2 ft Material: Nylon 66	Carga Máxima: 50 kg Longitud: 1000 mm Material: Nylon 66
TR-M10	Max. Load= 176 lbs Lenght= 3.2 ft Material: Nylon 66	Carga Máxima: 80 kg Longitud: 1000 mm Material: Nylon 66



Nylon Panel Screw - Tornillo de Nylon para Panel

Código / Code	Description	Descripción
BBNPLM10x150N	Nylon Screw Model 3/8 x 6 in	Tornillo de Nylon Modelo 10 x 150 mm
BBNPLM12x150N	Nylon Screw Model 1/2 x 6 in	Tornillo de Nylon Modelo 12 x 150 mm

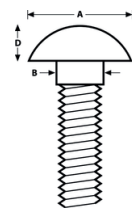

Insulation Disc and Cap - Disco de Aislamiento y Tapa

Código / Code	Description	Descripción
Insuldisc M8	Nylon Disc Max. Load: 440 lbs	Disco de Nylon Carga Máxima: 200 kg
Insuldisc M10	Nylon Disc Max. Load: 606 lbs	Disco de Nylon Carga Máxima: 275 kg

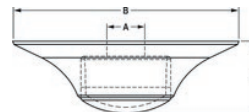

Cap and Washer - Tapa y Arandela

Código / Code	Description	Descripción
CW-CAPM6	Polypropylene Cap	Tapa de Polipropileno

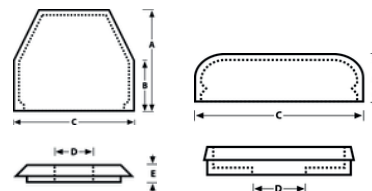

Bolt and Nut Covers - Tapa de protección para Tuerca y Tornillo

Código / Code	Description	Descripción
PC-M10W	19.5 x 9 x 21.3 x 17	3/4 x 3/8 x 7/8 x 2/3

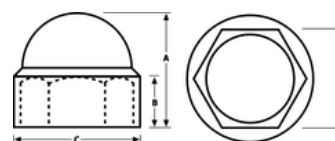

Complementos - Installation Complements

2 3/8" Washer - Arandela de 60mm

Description	Descripción
For TEC 164 and TEC 166	Para TEC 164 y TEC 166

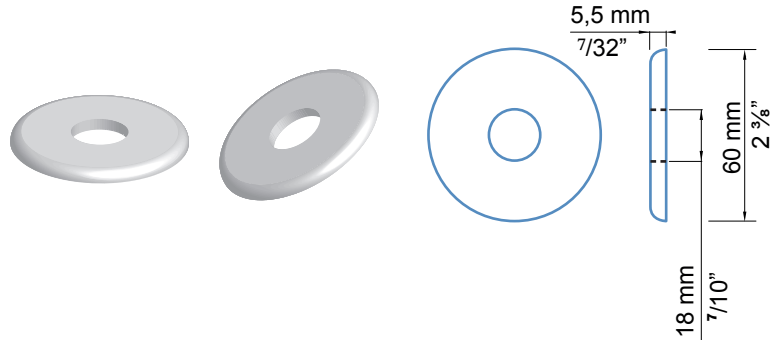

Flat Washer - Rondana para Distribución de Carga

Código / Code	Description	Descripción
WN-M8 STD	Nylon 1/3" x 1 3/4" x 3/16"	Nylon 8.5 mm x 45 mm x 4.5 mm
WN-M10 STD	Nylon 7/16" x 1 3/4" x 3/16"	Nylon 11.5 mm x 45 mm x 4.5 mm

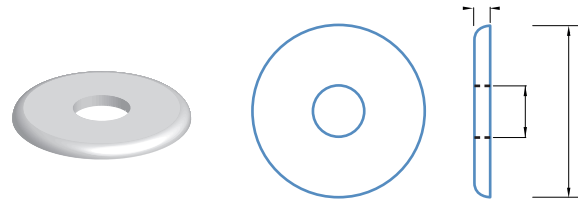

Hex Flange Nut - Tuerca Hexagonal con Arandela Integrada

Código / Code	Description	Descripción
WF-M10N	Nylon 3/8" x 2 3/8" x 7/8"	Nylon 10 mm x 16.7 mm x 22 mm

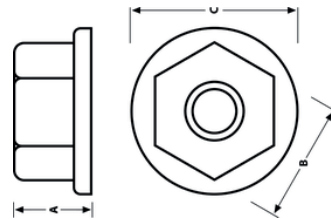

M10 Bolt - Bulon M10

Description	Descripción
Galvanized M10 clamp	Orquilla M10 galvanizada

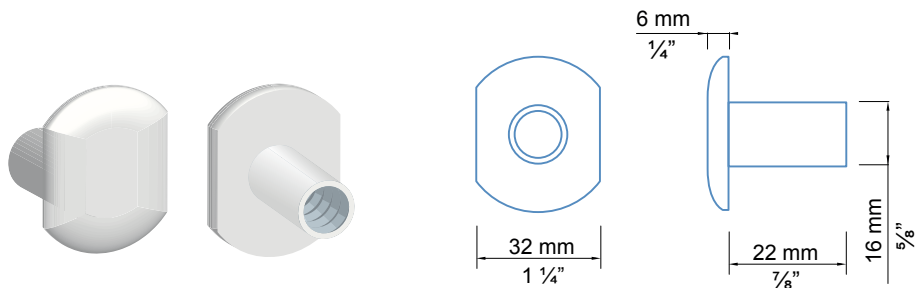

Complementos - Installation Complements

Capeloti Isocop - Isocop fastening clip



Para Panel Isocop - For Isocop Panel

Code - Código	Material
	Acero Galvanizado - Galvanized Steel
	Acero RAL 9010 / 9002 - RAL Color 9010 / 9002 Steel
51000010	Terracota

Clip de fijación de muro - Wall fastening clip

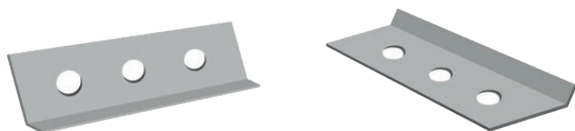

Code - Código	Dimensiones - Dimensions	Material
510000310	80 x 24 x 2 mm 3" x 1" x 9/64 mm	Acero Galvanizado Galvanized Steel
5100003104	80 x 24 x 2 mm (3 barrenos) 3" x 1" x 9/64 mm (3 drill bits)	Acero Galvanizado Galvanized Steel

- Diseñado para isoparete plissé. Diámetro de barreno 7mm
- Designed for striated isoparete. Drill hole diameter 1/4"

Cinta de butilo - Butyl tape

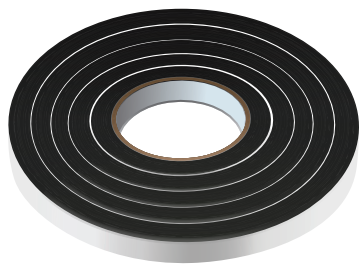

Code - Código	Dimensiones - Dimensions
12420000	6 x 10 mm - 1/4" x 3/8"
PROPIEADES / Properties	
Densidad / Density: lb/ft ³ (kg/m ³)	9 (144)
Adhesión / Adhesion: peel 90°, oz/in (N/cm)	37.0 (405)
Resistencia a la tensión / Tensile strength: psi (kPa)	40 (276)
Elongación de la espuma / Foam elongation	100%
Dureza / Hardness: 00	28
Abosrcion al agua/ Water absorption: %	2.5
Fuerza para comprimir / Compressive strength: 30% PSI (kPa)	3.5 (24)
Defelxión al comprimir / Compressive deflection: PSI (kPa)	2.0 (14)
Compresión al fijarse / Compression on setting: %	8
Temperatura de aplicación / Application temperature	4 °C a 52 °C (40 °F a 125 °F)
Temperatura de trabajo / Working temperature	-26 °C a 71 °C (-15 °F a 160 °F)

Sellador de silicon - Silicone sealant



Code - Código	Dimensiones - Dimensions
SIG000000	300ml
PROPIEADES / Properties	
Base Química / Chemical base	New formulation of polyurethane
Apariencia / Aspect	Pasta / Paste
Densidad / Density	1.3 gr/ml - 173.1 oz/Gal
Tiempo sin tensión / Tack-free time	90 min
Proporción de curado / Curing ratio	3 mm/día - 0.1 in / day
Temperatura de Aplicación / Application temperature	+5° C to +40°C - 41°F a 104°F
Temperatura de trabajo / Service temperature	-30°C to +80°C -22°F to 176°F
Dureza / Hardness	Shore A 30
Resistencia de Tracción / Tensile strength	0,72 N/mm ² 104.4 Lb/in ²
Elongación / Elongation	>500%
Capacidad de movimiento / Movement capacity	50 %
VOC	0.0000019 g/l

Complementos - Installation Complements

Ceiling Tee - Perfil T



Color	Dimensiones - Dimensions	Material
Blanco hueso	4.8 m x 10 cm, 8mm de espesor en pieza vertical con orificios pre-perforados	6061-T6 Aluminio de alta resistencia
Blanco hueso	16"x 4", 5/16" thick vertical leg w/pre-punched holes	6061-T6 High Strength Aluminium

Splice plate and accesories kit - Placa de empalme y accesorios

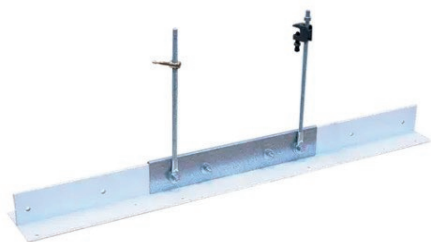

Dimensiones - Dimensions	Material
Perfil T de 10 cm (Incluye placa y tornillos de fijación, turcas y arandelas)	Acero Galvanizado
4" wide tee (Kit includes splice plate set, bolts, nuts & washers)	Galvanized Steel

Closure Isocop



Code - Código	Tipo - Type	Uso - Application
5100009118	4 crestas 4 rows	Acero Galvanizado Galvanized Steel

Linear working length 3ft - Long. de trabajo 1 m

Láminas lisas (Color Estandar) - Plain sheets (Standard colors)



Color	Dimensiones - Dimensions	Material
9010 / 9002	4" x 10" (50 pzas) calibre 24 y 26 4" x 10" (50 pcs) gauge 24 y 26	Acero - Steel

Láminas Lisas (Color Especial) - Plain sheets (Special colors)

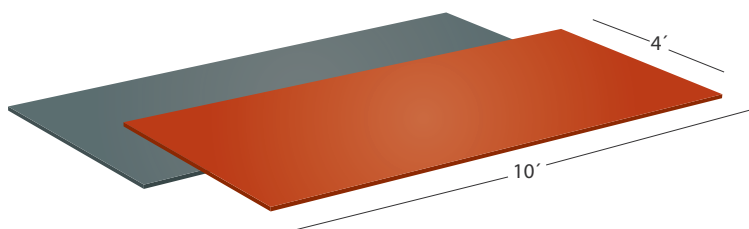

Color	Dimensiones - Dimensions	Material
*Color Especial - Special Color	4" x 10" (50pzas) gauge 24 y 26 4" x 10" (50 pcs) gauge 24 y 26	Acero - Steel

*A reserva de disponibilidad de acero
*Subject to steel availability

Complementos - Installation Complements

Isolite 40/2.5

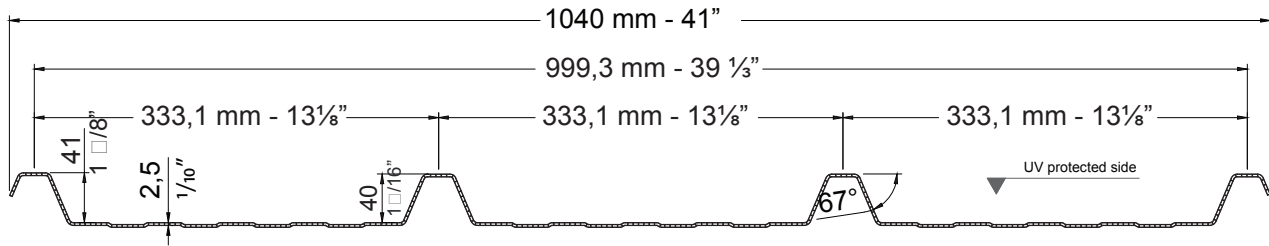
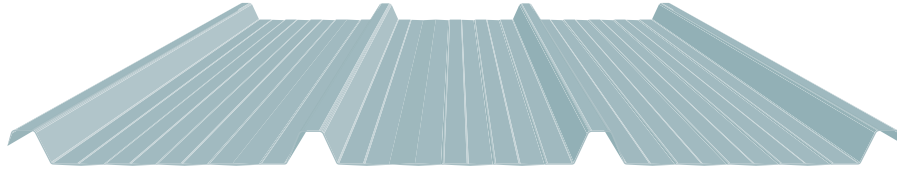

Isolite 40/8

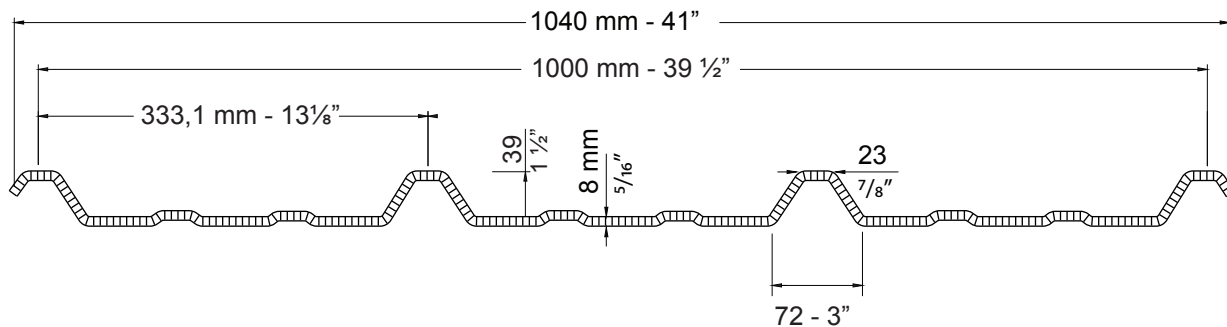
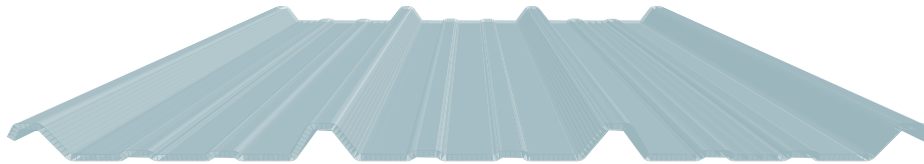

Complementos - Installation Complements

Isolite Wall 40/10

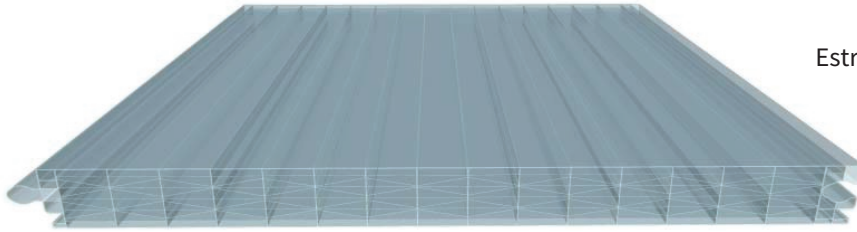

Estructura: 11 paredes por celda 40 mm
11 partitions per cell 1 1/16"

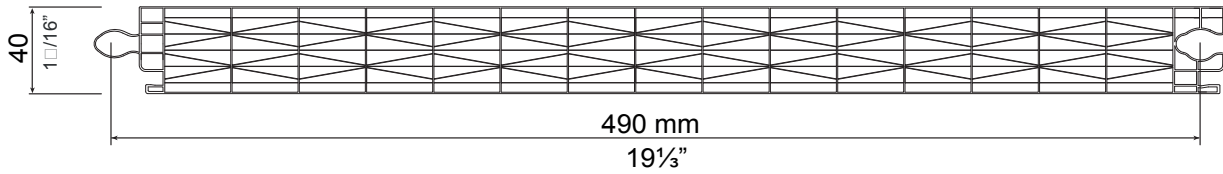

Isolite lisa 30

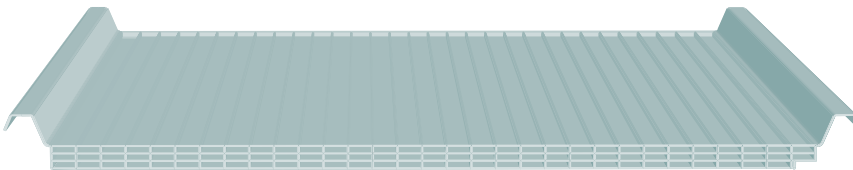

Estructura: 4 paredes por celda
4 partitions per cell

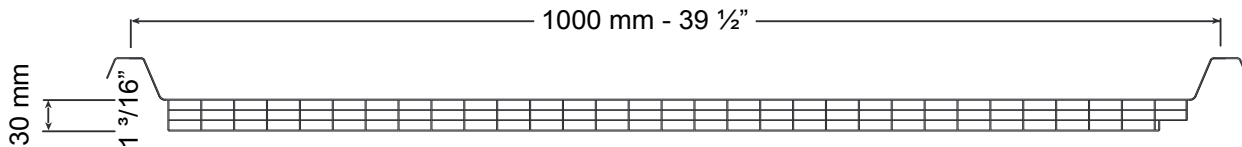

Trims - Molduras

Channel wrap trim - Canal "U"

ISO L 0

External Pre-painting - Prepintado Externo

Panel thickness - Espesor del panel	Develop - Desarrollo
1"	8 1/8" - 206mm
1 1/4"	8 3/8" - 213mm
1 1/2"	8 5/8" - 219mm
1 5/8"	8 3/4" - 222mm
2"	9 1/8" - 232mm
2 1/2"	9 5/8" - 245mm
3"	10 1/8" - 257mm
4"	11 1/8" - 283mm
5"	12 1/8" - 308mm
6"	13 1/8" - 333mm
8"	15 1/8" - 384mm

Code - Código	Material
ISO L 0	Steel gauge 26 & 24 - Acero calibre 26 o 24

Linear working length 10 ft - Long. de trabajo 3.05 m lineales

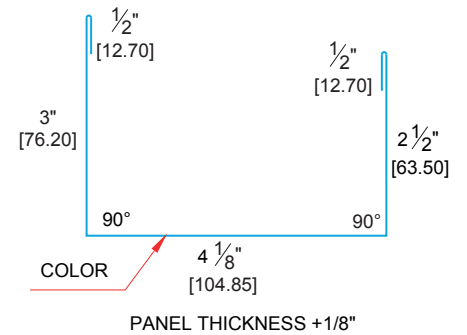
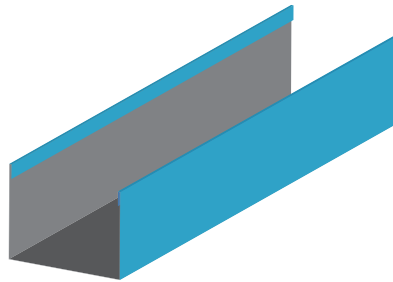

Drip edge profile - Perfil goterón para todos los tipos

ISO L 1a

External Pre-painting - Prepintado Externo

Develop - Desarrollo	Code - Código	Material
16 3/8" 416 inch mm	ISO L 1a	Steel gauge 26 & 24 - Acero calibre 26 o 24

Linear working length 10 ft - Long. de trabajo 3.05 m lineales

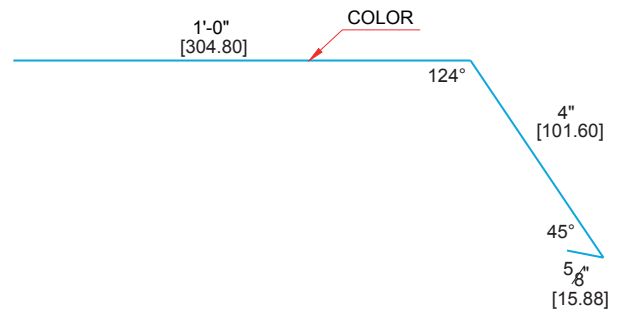
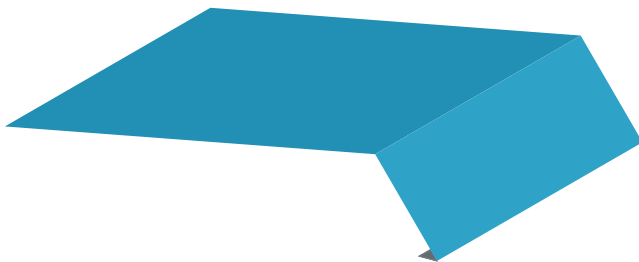

Trims - Molduras

Corner trim for wall and roof panel external joint - Moldura angular para lado exterior de juntas de muro y techo

ISO L 2a

External Pre-painting - Prepintado Externo

Develop - Desarrollo		Code - Código	Material
16%	416	ISO L 2a	Steel gauge 26 & 24 - Acero calibre 26 o 24
inch	mm		

Linear working length 10 ft - Long. de trabajo 3.05 m lineales

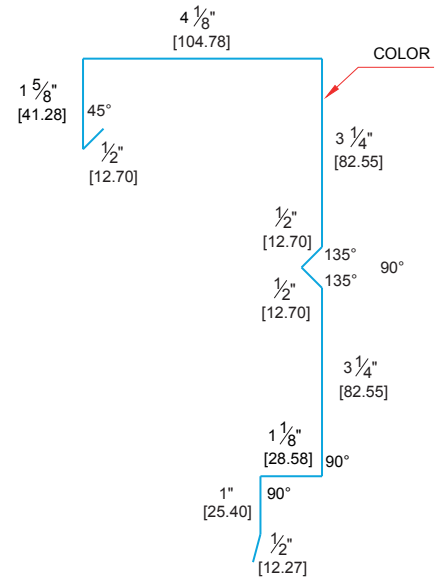

Protective coping for parapets - Moldura protectora para parapetos

ISO L 4

External Pre-painting - Prepintado Externo

Develop - Desarrollo		Code - Código	Material
12%	312	ISO L 4	Steel gauge 26 & 24 - Acero calibre 26 o 24
inch	mm		

Linear working length 10 ft - Long. de trabajo 3.05 m lineales

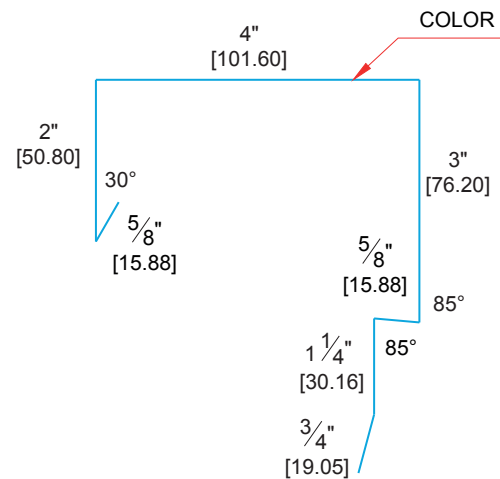

Trims - Molduras

Angle trim for wall panel internal joint - Moldura angular para lado interno de juntas de panel de muro

ISO L 6

External Pre-painting - Prepintado Externo

Develop - Desarrollo		Code - Código	Material
10"	250	ISO L 6	Steel gauge 26 & 24 - Acero calibre 26 o 24
inch	mm		

Linear working length 10 ft - Long. de trabajo 3.05 m lineales
Check with customer for bending angle - Consultar con cliente ángulo de doblez

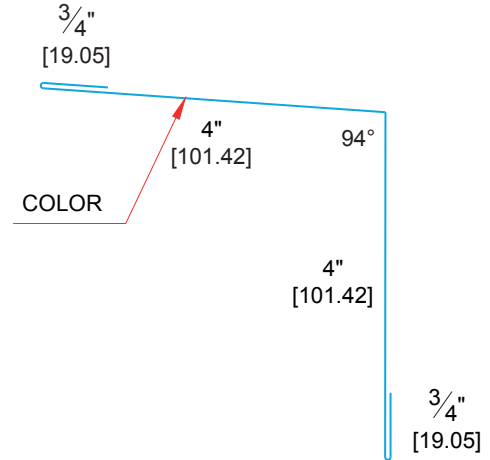
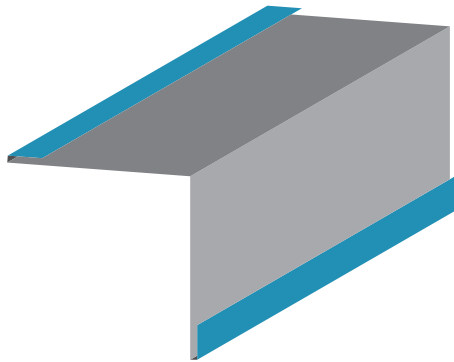

Outside corner trim - Esquinero externo

ISO L 7

External Pre-painting - Prepintado Externo

Develop - Desarrollo		Code - Código	Material
5"	125	ISO L 7	Steel gauge 26 & 24 - Acero calibre 26 o 24
inch	mm		

Linear working length 10 ft - Long. de trabajo 3.05 m lineales

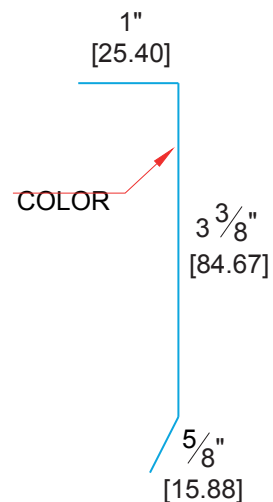
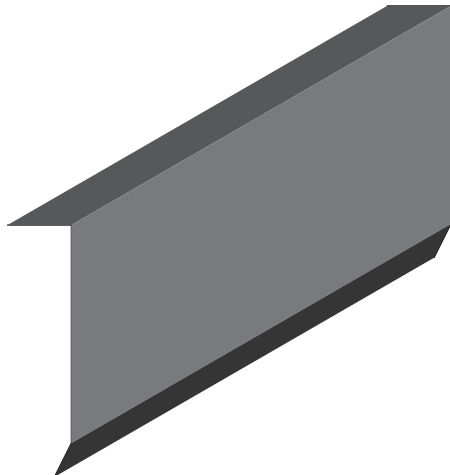

Trims - Molduras

Wall Panel Base Trim - Remate para paneles de muro

ISO L 8

External Pre-painting - Prepintado Externo

Develop - Desarrollo		Code - Código	Material
6"	156	ISO L 8	Steel gauge 26 & 24 - Acero calibre 26 o 24
inch	mm		

Linear working length 10 ft - Long. de trabajo 3.05 m lineales

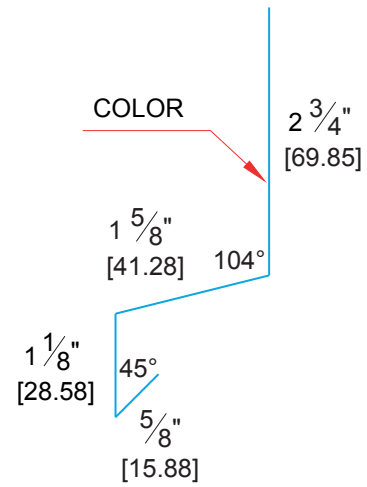
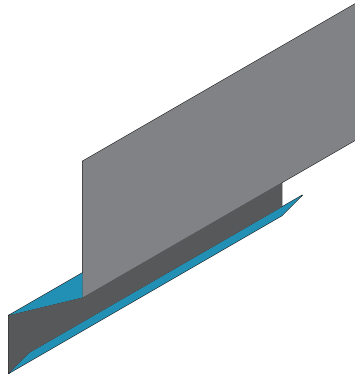

Simple ridge trim - Cumbra simple para todos los perfiles

ISO L 10 D

External Pre-painting - Prepintado Externo

Develop - Desarrollo		Code - Código	Material
16%	416	ISO L 10D	Steel gauge 26 & 24 - Acero calibre 26 o 24
inch	mm		

Linear working length 10 ft - Long. de trabajo 3.05 m lineales

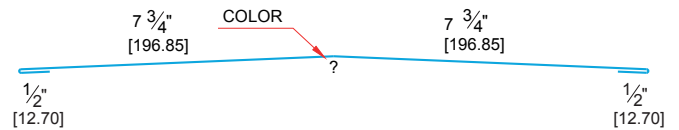
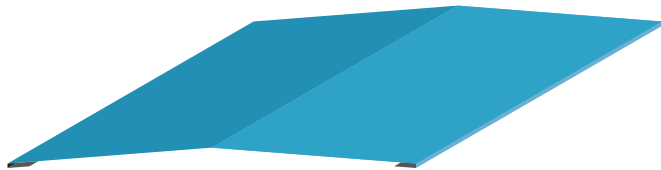

Trims - Molduras

Simple sub-ridge trim - Subcumbre simple para todos los tipos

ISO L 11

External Pre-painting - Prepintado Externo

Develop - Desarrollo		Code - Código	Material
25"	624	ISO L 11	Steel gauge 26 & 24 - Acero calibre 26 o 24
inch	mm		

Linear working length 10 ft - Long. de trabajo 3.05 m lineales

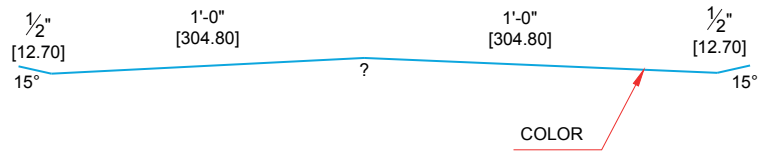
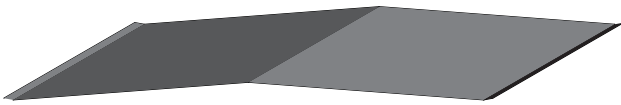

Cover Trim - Cubierta para todos los perfiles

ISO L 12a

External Pre-painting - Prepintado Externo

Develop - Desarrollo		Code - Código	Material
25"	624	ISO L 12a	Steel gauge 26 & 24 - Acero calibre 26 o 24
inch	mm		

Linear working length 10 ft - Long. de trabajo 3.05 m lineales

- Specify overlap length - Especificar longitud de traslape
- No cut solution - Solución sin corte
- Important to combine trim with closure - Importante combinar moldura con closure
- Linear working length 120" - Long. de trabajo 3.05 m lineales

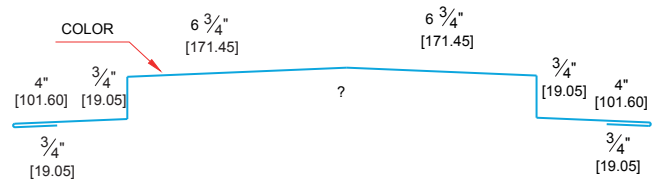
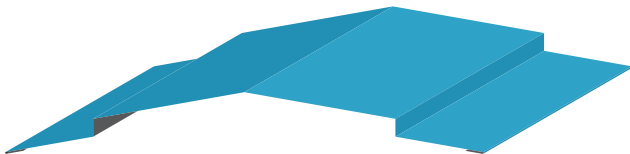

Trims - Molduras

Cantilever roof edge trim - Moldura de borde para techos con cantiliver

ISO L 13

External Pre-painting - Prepintado Externo

Development - Desarrollo	
12"	312
inch	mm

Code - Código	Material
ISO L 13	Steel gauge 26 & 24 - Acero calibre 26 o 24

Linear working length 10 ft - Long. de trabajo 3.05 m lineales

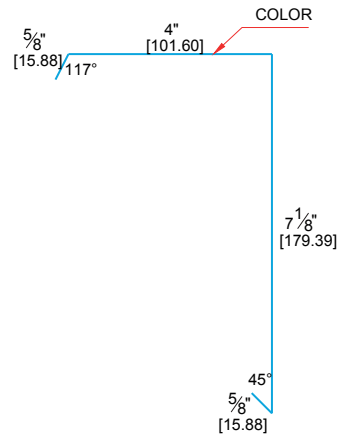

Corner trim for wall and roof panel internal joint - Moldura angular para lado interno de juntas de muro y techo

ISO L 14

External Pre-painting - Prepintado Externo

Develop - Desarrollo	
6"	156
inch	mm

Code - Código	Material
ISO L 14	Steel gauge 26 & 24 - Acero calibre 26 o 24

Linear working length 10 ft - Long. de trabajo 3.05 m lineales

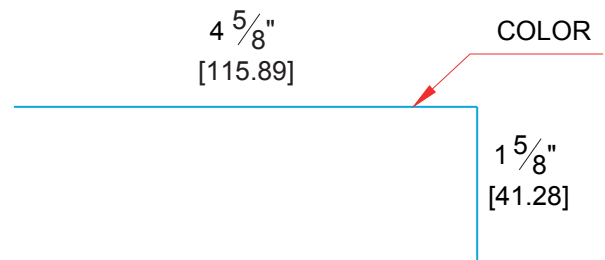
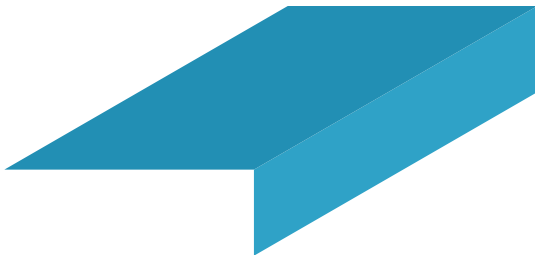

Trims - Molduras

Exterior trim molding for wall and ceiling joints - Moldura protectora para juntas exteriores de muro y techo

ISO L 15

External Pre-painting - Pre-pintado Externo

Development - Desarrollo		Code - Código	Material
25"	624	ISO L 15	Steel gauge 26 & 24 - Acero calibre 26 o 24
inch	mm		

Linear working length 10 ft - Long. de trabajo 3.05 m lineales

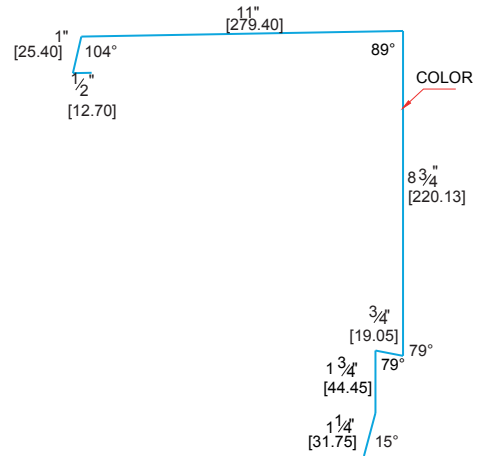

Corner trim for wall and roof panel internal joint - Moldura angular para lado interno de juntas de muro y techo

ISO L 18

External Pre-painting - Pre-pintado Externo

Develop - Desarrollo		Code - Código	Material
12 1/4"	312	ISO L 18	Steel gauge 26 & 24 - Acero calibre 26 o 24
inch	mm		

Linear working length 10 ft - Long. de trabajo 3.05 m lineales

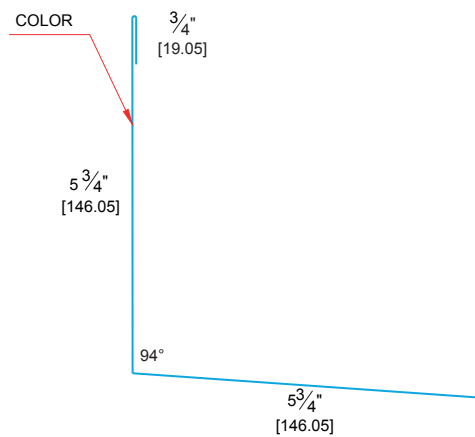
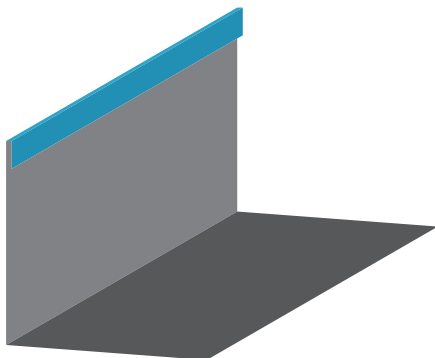

Trims - Molduras

Angle trim for lower joints / Moldura angular para todas las juntas inferiores

ISO L 19

External Pre-painting - Prepintado Externo

Develop - Desarrollo		Code - Código	Material
16 3/8"	416	ISO L 19	Steel gauge 26 & 24 - Acero calibre 26 o 24
inch	mm		

Linear working length 10 ft - Long. de trabajo 3.05 m lineales
 - Specify overlap length - Especificar longitud de traslape
 - Linear working length 120" - Long. de trabajo 3.05 m lineales

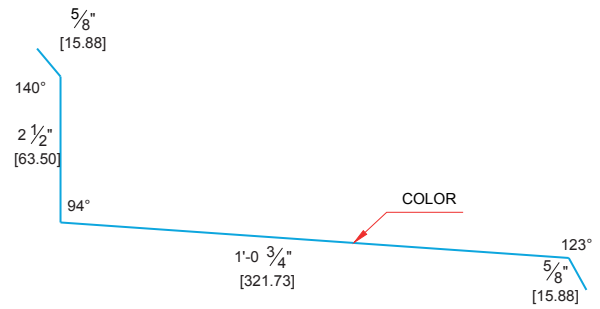
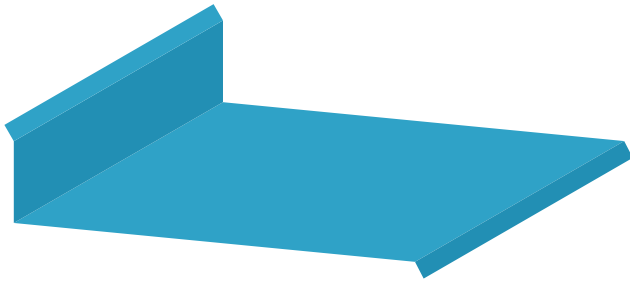

Check with customer for bending angle
 Consultar con cliente ángulo de doblez

Horizontal drip edge trim for horizontal wall - Goterón horizontal para junta horizontal de muro

ISO L 20

External Pre-painting - Prepintado Externo

Develop - Desarrollo		Code - Código	Material
7"	178	ISO L 20	Steel gauge 26 & 24 - Acero calibre 26 o 24
inch	mm		

Linear working length 10 ft - Long. de trabajo 3.05 m lineales

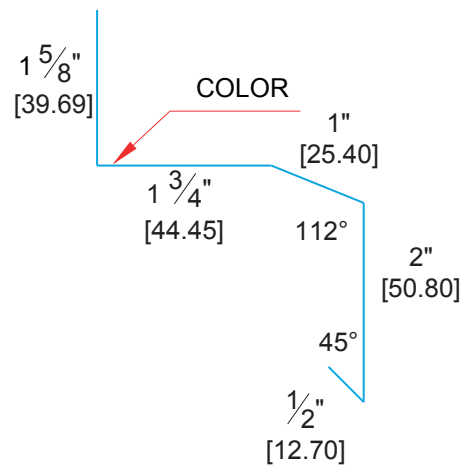
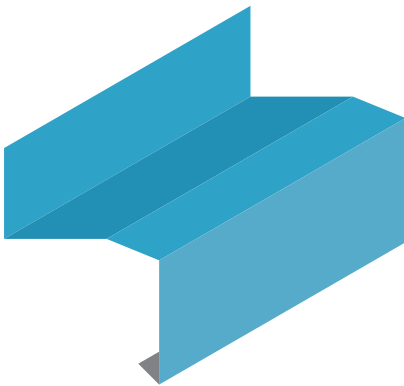

Trims - Molduras

Corner trim for wall and roof panel internal joint - Moldura angular para lado interno de juntas de muro y techo

ISO L 22

External Pre-painting - Pre-pintado Externo

Develop - Desarrollo		Code - Código	Material
6 "	156	ISO L 22	Steel gauge 26 & 24 - Acero calibre 26 o 24
inch	mm		

Linear working length 10 ft - Long. de trabajo 3.05 m lineales

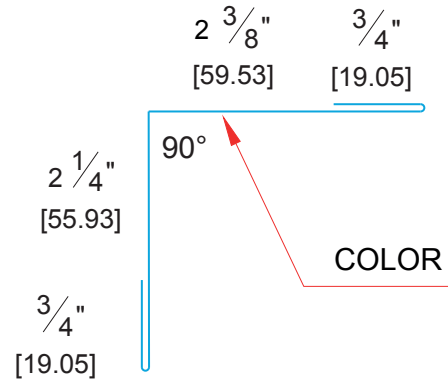
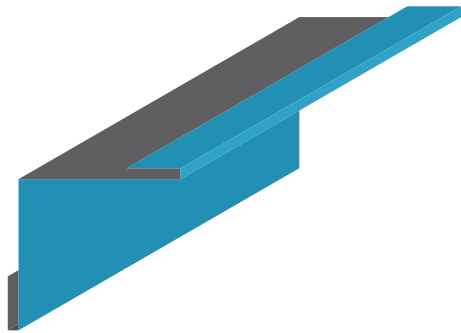

Cover trim for expansion joints - Moldura de tapa para juntas móviles

ISO L 23

External Pre-painting - Pre-pintado Externo

Develop - Desarrollo		Code - Código	Material
6 "	156	ISO L 23	Steel gauge 26 & 24 - Acero calibre 26 o 24
inch	mm		

Linear working length 10 ft - Long. de trabajo 3.05 m lineales

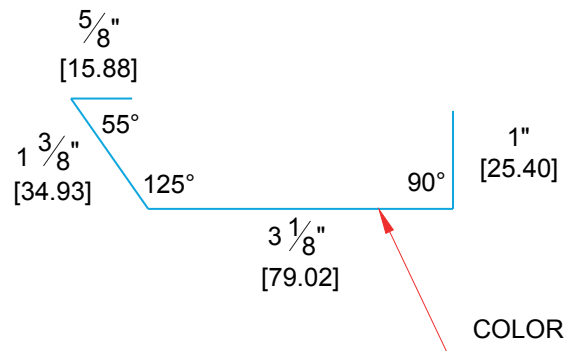
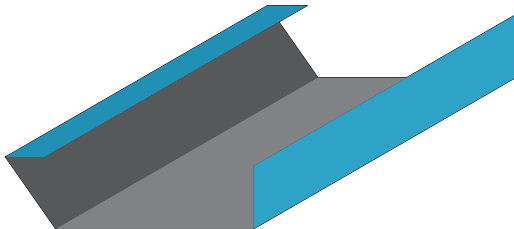

Trims - Molduras

Cover trim for expansion joints - Moldura de tapa para juntas móviles

ISO L 24

External Pre-painting - Prepintado Externo

Develop - Desarrollo		Code - Código	Material
8 3/8"	221	ISO L 24	Steel gauge 26 & 24 - Acero calibre 26 o 24
inch	mm		

Linear working length 10 ft - Long. de trabajo 3.05 m lineales

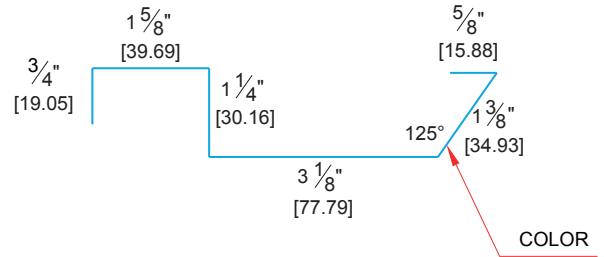

External cover trim for vertical joints - Moldura tapa externa para juntas verticales

ISO L 26b

External Pre-painting - Prepintado Externo

Develop - Desarrollo		Code - Código	Material
16 3/8"	416	ISO L 26b	Steel gauge 26 & 24 - Acero calibre 26 o 24
inch	mm		

Linear working length 10 ft - Long. de trabajo 3.05 m lineales

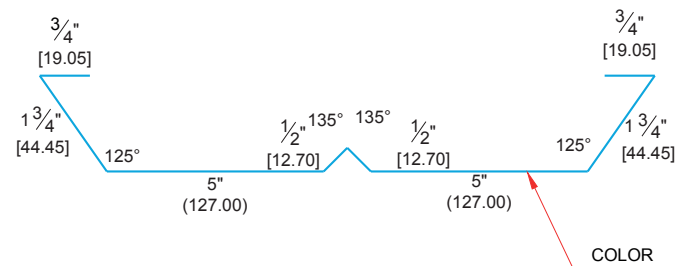

Trims - Molduras

External cover trim for vertical joints - Moldura tapa externa para juntas verticales

ISO L 27

External Pre-painting - Prepintado Externo

Develop - Desarrollo		Code - Código	Material
5"	125	ISO L 27	Steel gauge 26 & 24 - Acero calibre 26 o 24
inch	mm		

Linear working length 10 ft - Long. de trabajo 3.05 m lineales

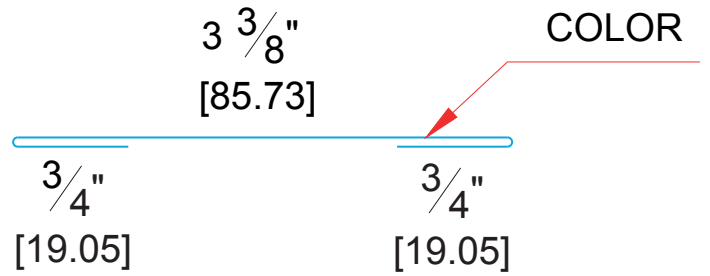
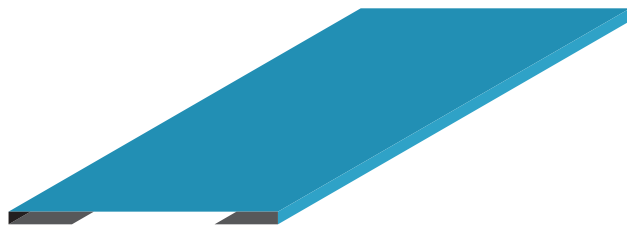

External cover trim for lower wall joint - Moldura tapa externa para junta inferior muro

ISO L 28

External Pre-painting - Prepintado Externo

Develop - Desarrollo		Code - Código	Material
16 1/8"	416	ISO L 28	Steel gauge 26 & 24 - Acero calibre 26 o 24
inch	mm		

Linear working length 10 ft - Long. de trabajo 3.05 m lineales

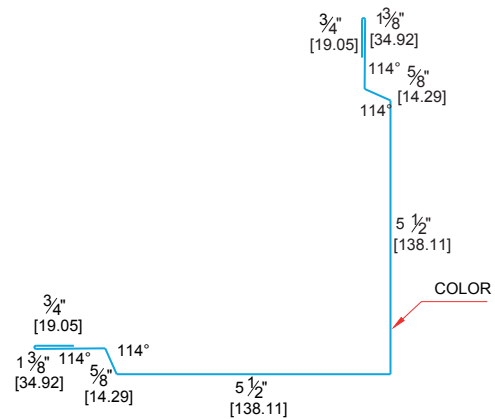
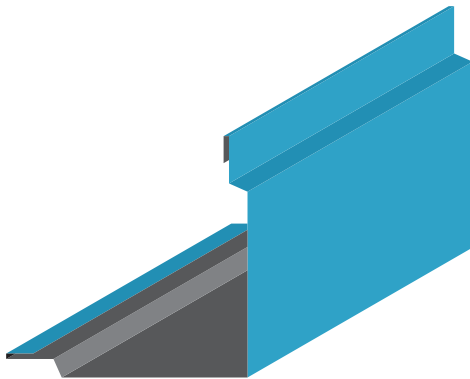

Trims - Molduras

External cover trim for bottom wall joint (Inverted angle) - Moldura tapa externa para junta inferior muro (Angulo invertido)

ISO L 30

External Pre-painting - Prepintado Externo

Develop - Desarrollo		Code - Código	Material
24 1/2"	624	ISO L 30	Steel gauge 26 & 24 - Acero calibre 26 o 24
inch	mm		

Linear working length 10 ft - Long. de trabajo 3.05 m lineales

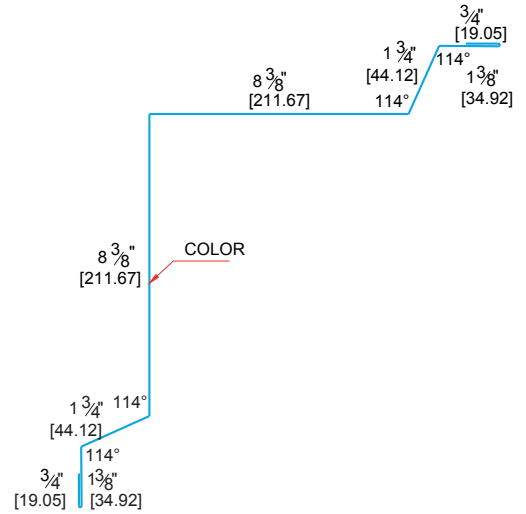
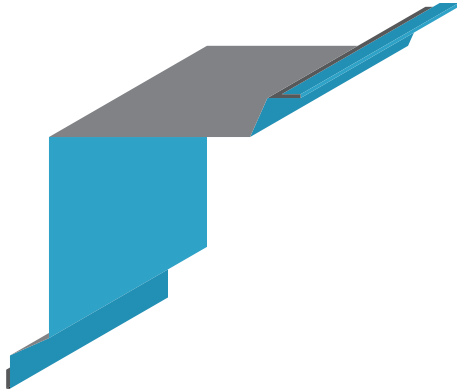

Internal trim cover for bottom wall joint - Moldura tapa interna para junta inferior muro

ISO L 32

External Pre-painting - Prepintado Externo

Develop - Desarrollo		Code - Código	Material
10"	250	ISO L 32	Steel gauge 26 & 24 - Acero calibre 26 o 24
inch	mm		

Linear working length 10 ft - Long. de trabajo 3.05 m lineales

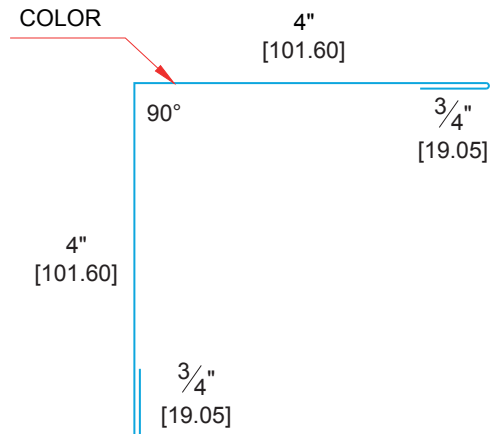
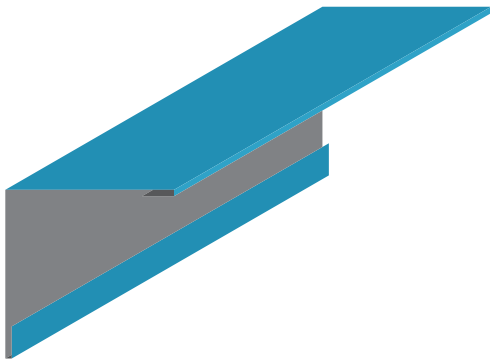

Trims - Molduras

Drip Edge - Goterón

ISO L 33

External Pre-painting - Prepintado Externo

Develop - Desarrollo		Code - Código	Material
10"	250	ISO L 33	Steel gauge 26 & 24 - Acero calibre 26 o 24
inch	mm		

Linear working length 10 ft - Long. de trabajo 3.05 m lineales



Internal trim cover for bottom wall joint - Moldura tapa interna para junta inferior muro

ISO L 34

External Pre-painting - Prepintado Externo

Develop - Desarrollo		Code - Código	Material
12 1/4"	312	ISO L 34	Steel gauge 26 & 24 - Acero calibre 26 o 24
inch	mm		

Linear working length 10 ft - Long. de trabajo 3.05 m lineales

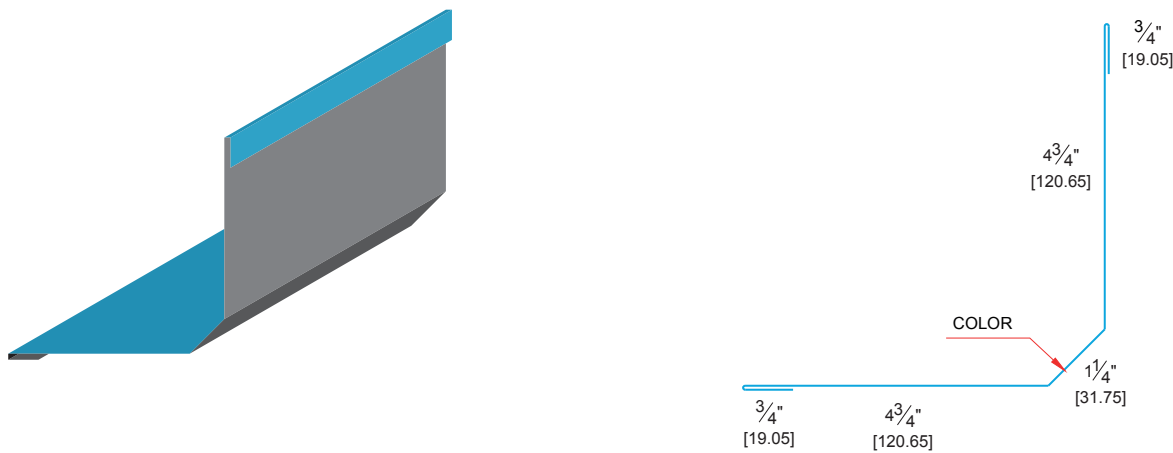

Trims - Molduras

Internal trim cover for bottom wall joint - Moldura tapa interna para junta inferior muro

ISO L 35

External Pre-painting - Prepintado Externo

Develop - Desarrollo		Code - Código	Material
16 1/2"	417	ISO L 35	Steel gauge 26 & 24 - Acero calibre 26 o 24
inch	mm		

Linear working length 10 ft - Long. de trabajo 3.05 m lineales

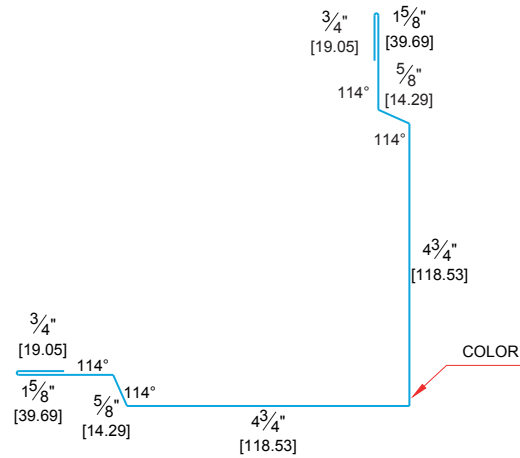
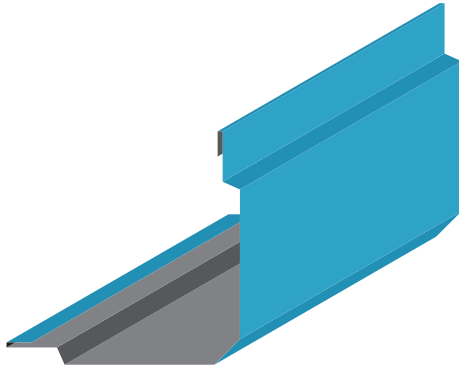

Gutter for all profiles Panel Thickness ≤ 2" - Canalón para todos los perfiles (espesor de panel ≤ 50mm)

ISO L 37

External Pre-painting - Prepintado Externo

Develop - Desarrollo		Code - Código	Material
16 1/2"	415	ISO L 37	Steel gauge 26 & 24 - Acero calibre 26 o 24
inch	mm		

Linear working length 10 ft - Long. de trabajo 3.05 m lineales

- Linear working length 120" - Long. de trabajo 3.05 m lineales

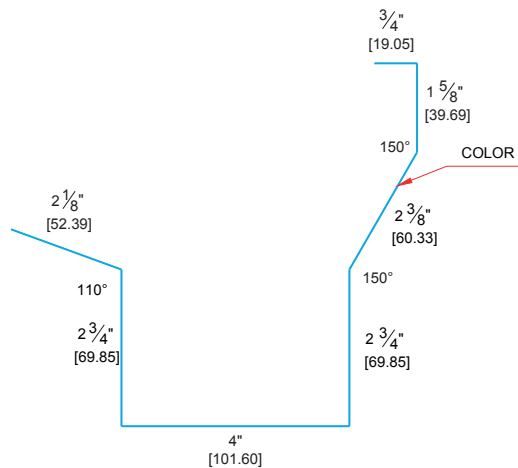
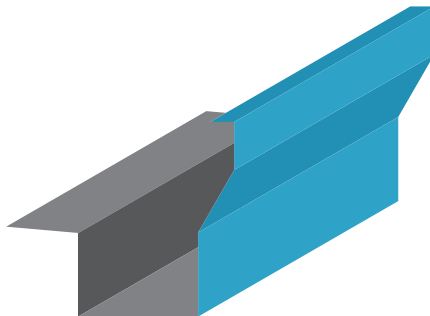

Trims - Molduras

Canalón para todos los perfiles (espesor de panel ≤50mm) - Gutter for all profiles (panel thickness ≤2")

ISO L 38

External Pre-painting - Prepintado Externo

Develop - Desarrollo		Code - Código	Material
24 1/2"	624	ISO L 38	Steel gauge 26 & 24 - Acero calibre 26 o 24
inch	mm		

Linear working length 10 ft - Long. de trabajo 3.05 m lineales

- Linear working length 120" - Long. de trabajo 3.05 m lineales

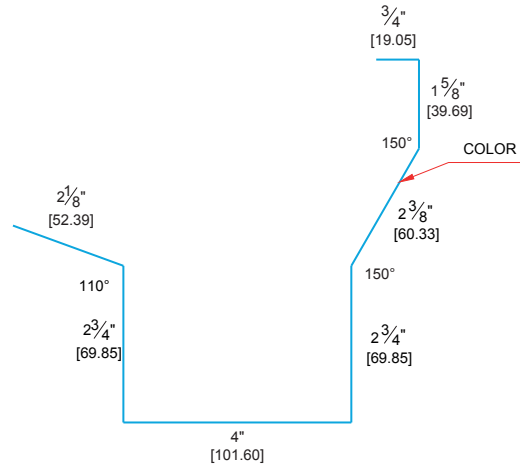
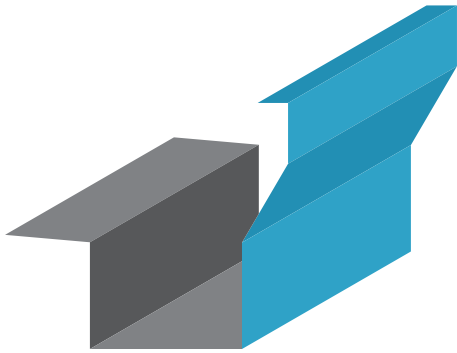

Joint Cap for 1 9/16" - Tapa junta para 40 mm

ISO L 45

External Pre-painting - Prepintado Externo

Develop - Desarrollo		Code - Código	Material
5 7/16"	138	ISO L 45	Steel gauge 26 & 24 - Acero calibre 26 o 24
inch	mm		

Linear working length 10 ft - Long. de trabajo 3.05 m lineales

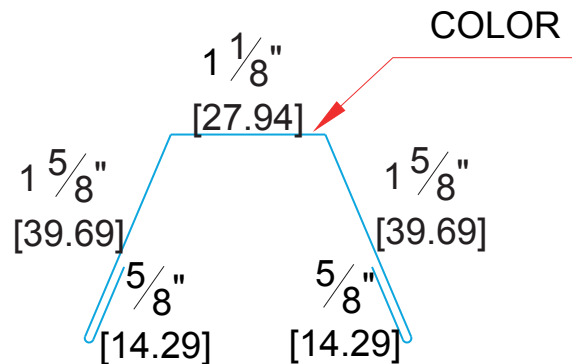
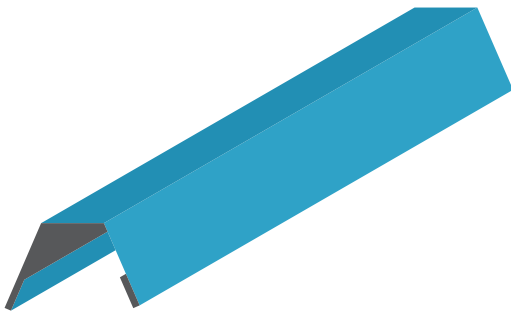

Trims - Molduras

Clip-on trim for corrugated roof panel - Tapa junta tipo clip para paneles de techo corrugado

ISO L 46

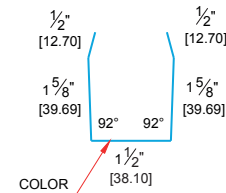
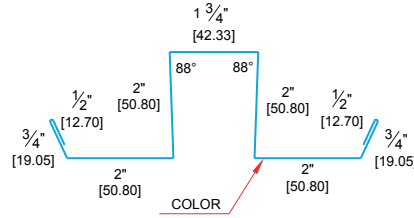
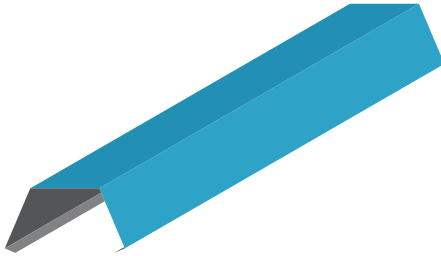

External Pre-painting - Prepintado Externo

Descripción - Description	Material
Tapajunta tipo Clip / Clip-on trim	Steel gauge 26 & 24 - Acero calibre 26 o 24
Tapajunta tipo Clip /Clip on trim	Steel gauge 26 & 24 - Acero calibre 26 o 24

Develop - Desarrollo	
4 9/16 + 3 5/8"	116 + 91
inch	mm

Tornillo autotaladrante cabeza plana - Self-drilling screw flat head	
Ø X LARGO	Ø X LENGHT
6,3 x 110 mm	1/4" x 4 1/3"
6,3 x 120 mm	1/4" x 4 3/4"
6,3 x 130 mm	1/4" x 5 1/8"
6,3 x 140 mm	1/4" x 5 1/2"
6,3 x 160 mm	1/4" x 6 1/4"
6,3 x 180 mm	1/4" x 7"
6,3 x 200 mm	1/4" x 8"

- Linear working length 120" - Long. de trabajo 3.05 m lineales



Tapa Junta / Trim



Clip

Corner molding for all bottom joints - Moldura adaptable angular para todas las juntas inferiores

ISO L 47

External Pre-painting - Prepintado Externo

Develop - Desarrollo	Code - Código	Material
12 1/4" 312 inch mm	ISO L 47	Steel gauge 26 & 24 - Acero calibre 26 o 24

Linear working length 10 ft - Long. de trabajo 3.05 m lineales

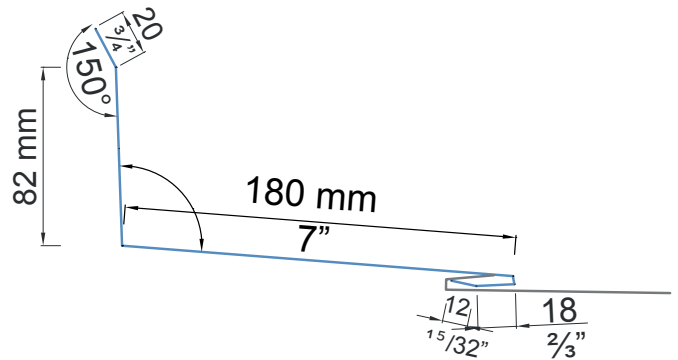
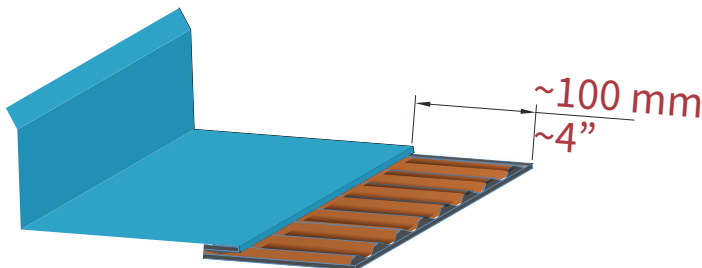

Trims - Molduras

Plane trim for striated isoparete - Junta plana para Isoparete plissé

ISO L 52

External Pre-painting - Prepintado Externo

Develop - Desarrollo	
10" + 4¼"	250 + 108
inch	mm

Code - Código	Material
ISO L 52	Steel gauge 26 & 24 - Acero calibre 26 o 24

Linear working length 10 ft - Long. de trabajo 3.05 m lineales

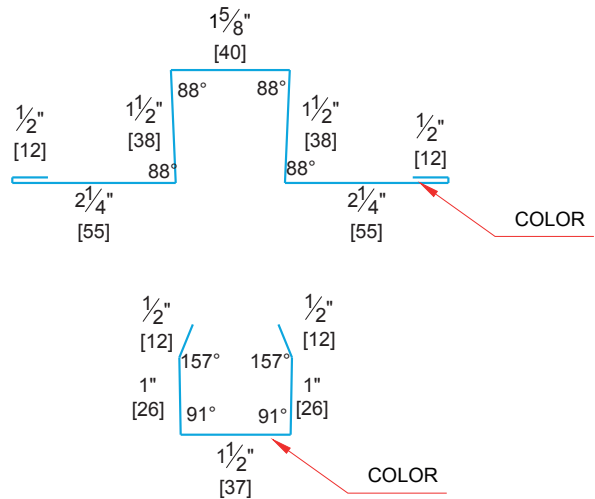
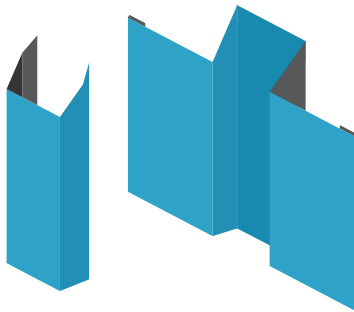

Ventilated ridge cap for roof - Moldura ventilada para juntas inferiores techo / muro Junta plana para Isoparete plissé - Plane joint for striated Isoparete

ISO L 54

External Pre-painting - Prepintado Externo

Develop - Desarrollo	
12 ¼" + 9 ¼"	312 + 235
inch	mm

Code - Código	Material
ISO L 54	Steel gauge 26 & 24 - Acero calibre 26 o 24

Linear working length 10 ft - Long. de trabajo 3.05 m lineales

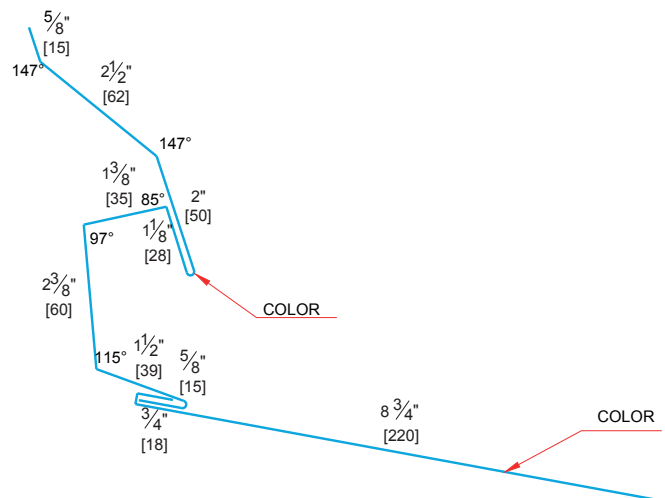
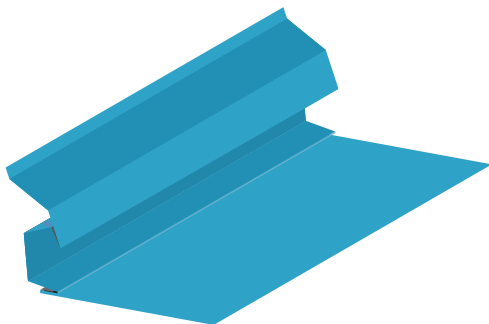

Trims - Molduras

Ventilated ridge cap for roof / wall - Moldura ventilada para juntas inferiores techo / muro

ISO L 54 PIANO

External Pre-painting - Pre-pintado Externo

Develop - Desarrollo		Code - Código	Material
12 1/4" + 10"	312 + 250	ISO L 54 PIANO	Steel gauge 26 & 24 - Acero calibre 26 o 24
inch	mm		

Linear working length 10 ft - Long. de trabajo 3.05 m lineales

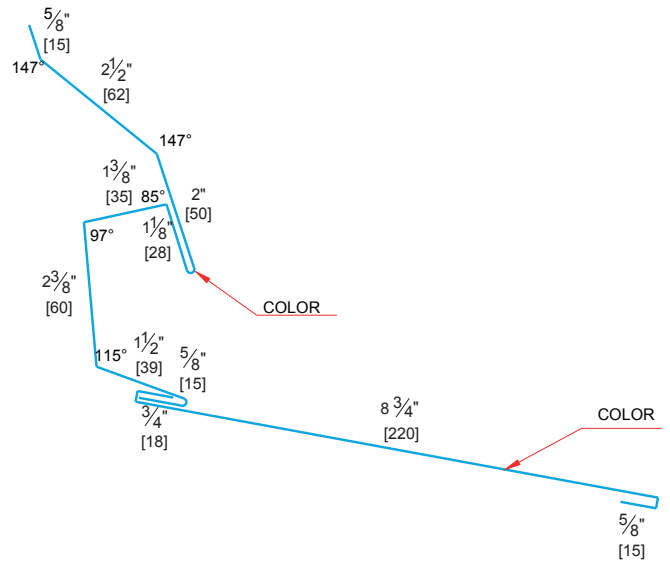
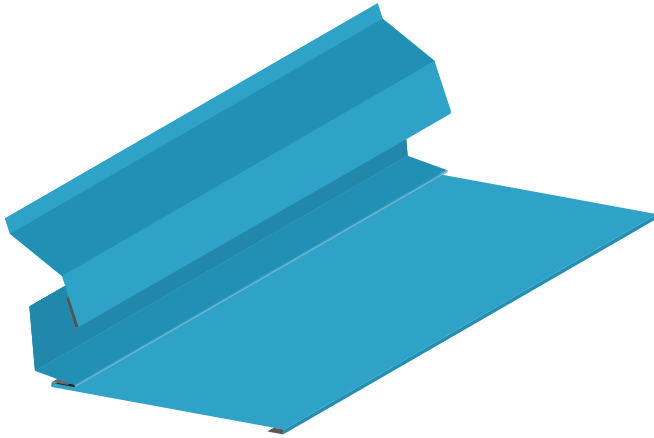



isocindU

Cindu - Isopan J.V.

ISOCINDU MÉXICO

Av. Libre Comercio #137
Puerto Interior Santa Fe III
Silao Gto. C.P. 36275
T. +52 472 800 7241

MANNI GREEN TECH USA

179 Hughes Landing Blvd
Suite 400, The woodlands TX
TX 77398
T. (281) 747-5588

MANNI GREEN TECH USA

77530 Enfield Lane,
Building D, Suite D2,
Palm Desert, California, 92211
T. (281) 747-5588

ISOPAN IBERICA
Terragona | Spain

ISOPAN SPA
Verona | Italy
Frosinone | Italy

ISOPAN EST
Popești-Leordeni | Romania

ISOPAN CZ
Terragona | Spain

ISOPAN FANCE
Mérignac | Spain



www.isocindu.com / atencionaclientes@isocindu.mx